

96 AVE

EAST VIEW CLOSE

EAST VIEW DRIVE







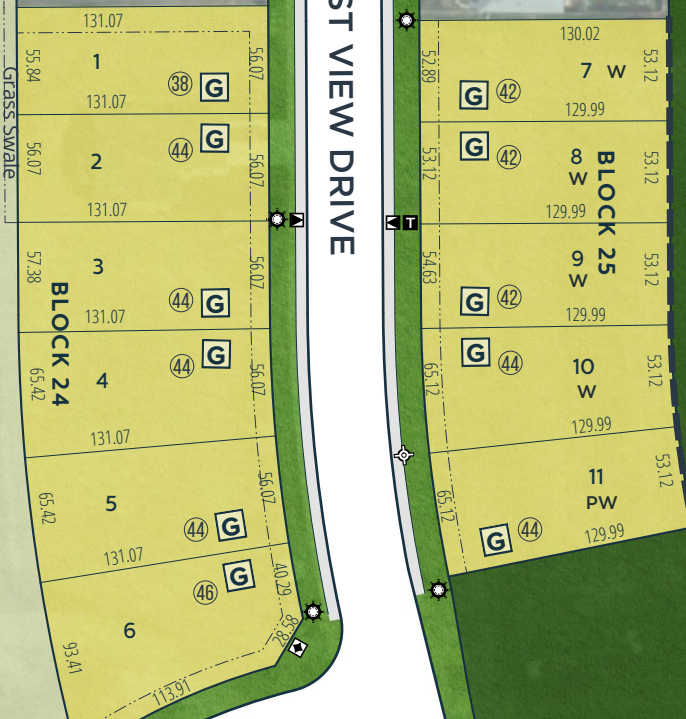

Existing Residential

Existing Residential

Future Residential

Storm Pond



-  Single Family
-  Suggested House Width in Feet @ 20 ft Front Setback
-  Driveway Location
-  Transformer
-  Light Standard
-  Telephone/Cable Pedestal
-  Hydrant
-  Utility Easement
-  Wood Screen Fence

JUNIPER HEIGHTS

STAGE 1



This plan is prepared as an information plan for prospective purchasers and is subject to change. Lot dimensions are in feet and rounded, and should be verified with a registered plan. Location of street furniture and landscaping are approximate and should be verified on site.