

96 AVE

EAST VIEW CLOSE

Existing Residential

Existing Residential

EAST VIEW DRIVE

Future Residential

Storm Pond

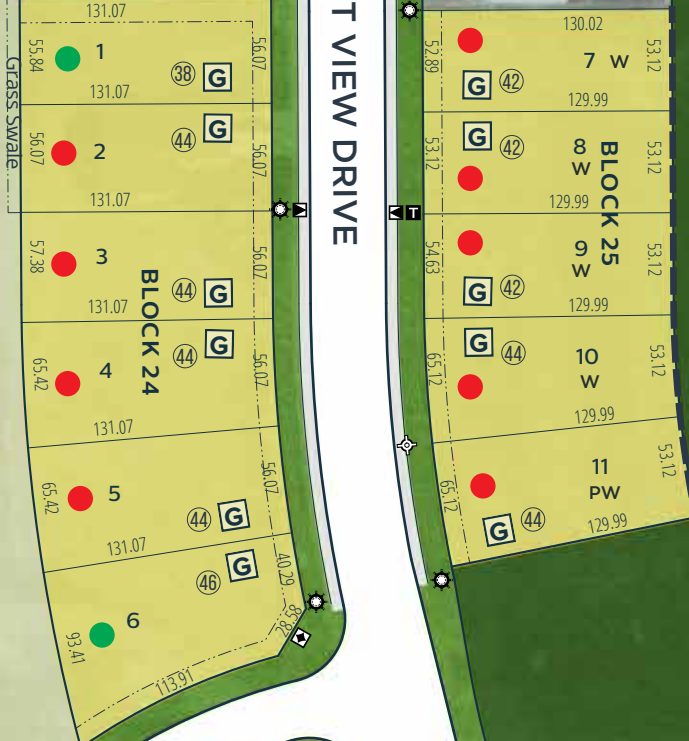

- Single Family
- 40 Suggested House Width in Feet @ 20 ft Front Setback
- G Driveway Location
- Transformer
- Light Standard
- Telephone/Cable Pedestal
- Hydrant
- Utility Easement
- Wood Screen Fence
- Available
- Sold

# JUNIPER HEIGHTS

STAGE 1



This plan is prepared as an information plan for prospective purchasers and is subject to change. Lot dimensions are in feet and rounded, and should be verified with a registered plan. Location of street furniture and landscaping are approximate and should be verified on site.



<b>Juniper Heights 1 Price List (Estate Lots)</b>			
<b>Block</b>	<b>Lot</b>	<b>Price</b>	
24	1	\$	138,219
24	6	\$	160,119

All prices subject to GST

**Contact:**

Mark Tanasichuk

780-486-3977

[mtanasichuk@tag.ca](mailto:mtanasichuk@tag.ca)